

WASHINGTON KEY MAP

SHEET INDEX	
SHEET NO.	TITLE
1	COVER SHEET
2	EXISTING SITE PLAN
3	SITE PLAN
4	RAMP PROFILE
5	FISHING PIER
6	ADA SWIM RAMP AND CONCRETE PATH
7	RAMP SECTION
8	FLOAT SECTION
9	PIER SECTION
10	ADA RAMP AND STAIRS SECTIONS
11	ADA CONCRETE RAMP PLAN
12	KAYAK ACCESS FLOAT PLAN

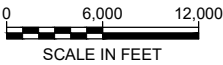

PROJECT SITE LOCATION



PURPOSE: REPLACE BOAT RAMP, PIER, PILES AND FLOATS
DATUM: NAD83 STATE PLANE WASHINGTON NORTH,
INTERNATIONAL FOOT (HORIZONTAL)
NAVD88 (VERTICAL)
ADJACENT PROPERTY OWNERS:
1. CITY OF SEATAC
2. KIMBERLY AND JIMMY VUONG (PARK PLACE PLAZA)
3. CHRISTOPHER THOMAS

**ANGLE LAKE PARK
WATERFRONT
IMPROVEMENTS**
COVER SHEET
APPLICATION BY:
CITY OF SEATAC

PROPOSED: NEW CONCRETE BOAT RAMP AND PIERS, NEW
ALUMINUM FLOATS AND NEW GALVANIZED
STEEL PILES
IN: ANGLE LAKE
NEAR / AT: SEATAC
COUNTY: KING
STATE: WASHINGTON
SHEET 1 OF 12 **DATE:** 2/14/25

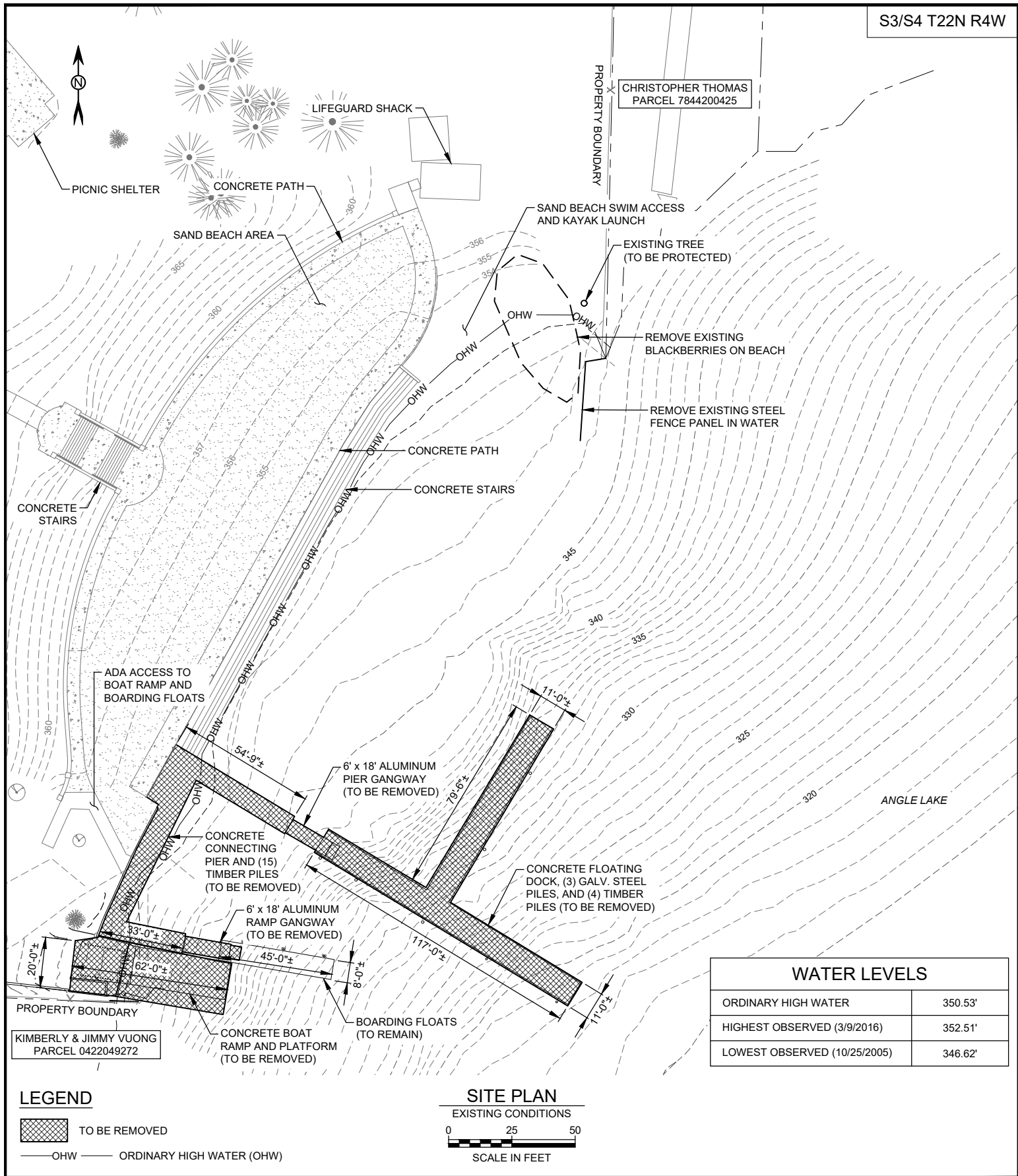

PURPOSE: REPLACE BOAT RAMP, PIER, PILES AND FLOATS

DATUM: NAD83 STATE PLANE WASHINGTON NORTH,
INTERNATIONAL FOOT (HORIZONTAL)
NAVD88 (VERTICAL)

ADJACENT PROPERTY OWNERS:

1. CITY OF SEATAC
2. KIMBERLY AND JIMMY VUONG (PARK PLACE PLAZA)
3. CHRISTOPHER THOMAS

ANGLE LAKE PARK WATERFRONT IMPROVEMENTS

EXISTING SITE PLAN

APPLICATION BY:
CITY OF SEATAC

PROPOSED:

NEW CONCRETE BOAT RAMP AND PIERS, NEW
ALUMINUM FLOATS AND NEW GALVANIZED
STEEL PILES

IN:

ANGLE LAKE

NEAR / AT:

SEATAC

COUNTY:

KING

STATE:

WASHINGTON

SHEET 2 OF 12

DATE: 2/14/25



c:\moll-use-cw\benlev.com\moll-use-pw-10\Documents\507102134-Port of Chinook Boat Launch and Facilities Improvement\Drawings_Models\12_MA_Marine\7-Design\CAD\F_Permit\Angle Lake Permit - Site Plan.dwg Feb 14, 2025 - 4:17PM MOR69830

PROJECT: ANGLE LAKE PARK WATERFRONT IMPROVEMENTS, SEATTLE, WA
DRAWN BY: J. HARRIS
CHECKED BY: J. HARRIS
DATE: 11/11/2025

PURPOSE: REPLACE BOAT RAMP, PIER, PILES AND FLOATS
DATUM: NAD83 STATE PLANE WASHINGTON NORTH,
INTERNATIONAL FOOT (HORIZONTAL),
NAVD88 (VERTICAL)
ADJACENT PROPERTY OWNERS:
1. CITY OF SEATAC
2. KIMBERLY AND JIMMY VUONG (PARK PLACE PLAZA)
3. CHRISTOPHER THOMAS

ANGLE LAKE PARK WATERFRONT IMPROVEMENTS RAMP PROFILE

PROPOSED: NEW CONCRETE BOAT RAMP AND PIERS, NEW
ALUMINUM FLOATS AND NEW GALVANIZED
STEEL PILES
IN: ANGLE LAKE
COUNTY: SEATAC
STATE: KING
WASHINGTON
SHEET 4 **OF** 12
DATE: 2/14/25

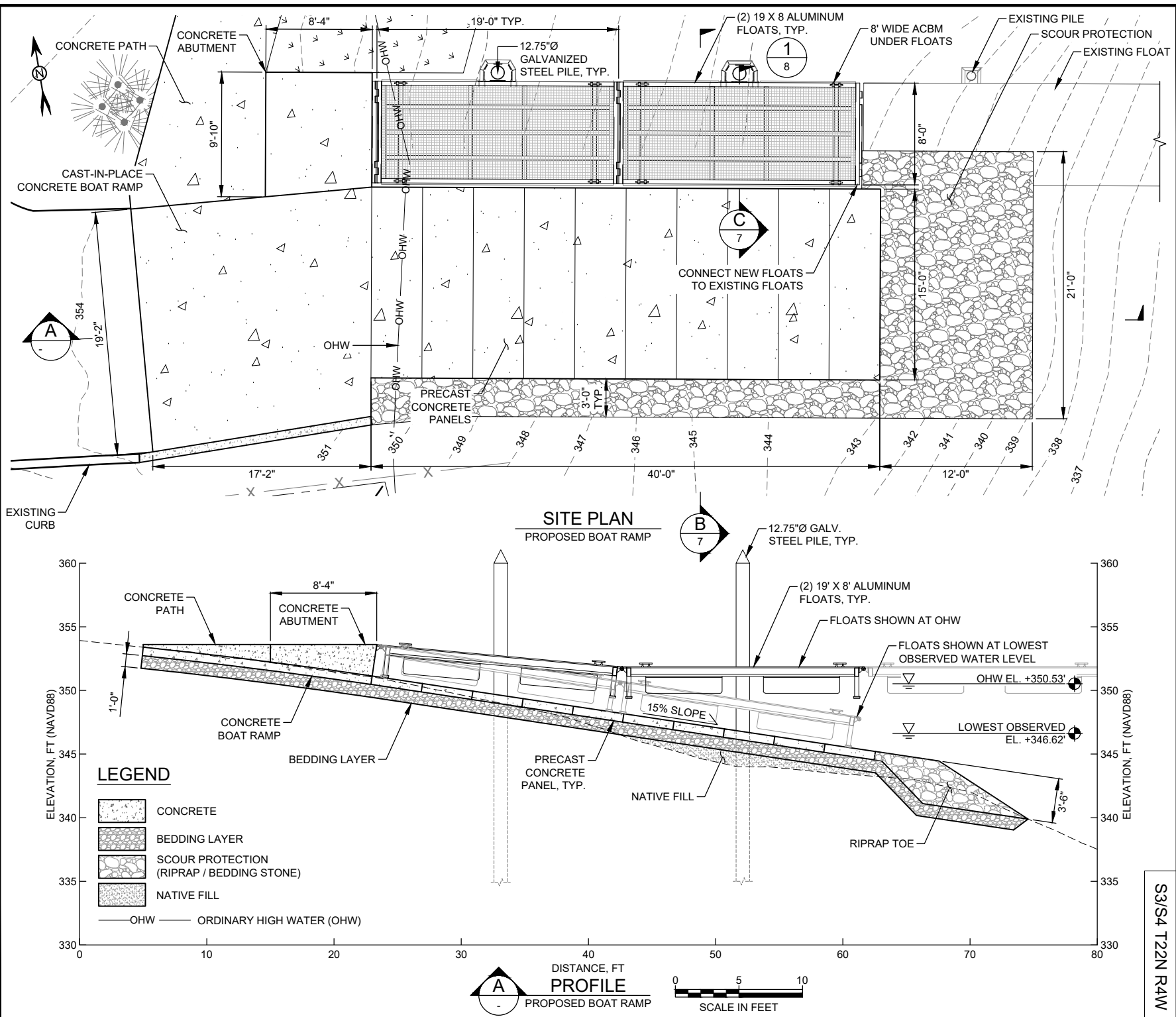

S3/S4 T22N R4W



ELEVATION, FT (NAVD88)



0
1
2
3
4
5
6
7
8
9
A
B
C
D
E
F
G
H
I
J
K
L
M
N
O
P
Q
R
S
T
U
V
W
X
Y
Z

NAVD88 (VERTICAL)

ADA SWIM RAMP AND CONCRETE PATH APPLICATION BY:

NEW CONCRETE BOAT RAMP AND PIERS, NEW
ALUMINUM FLOATS AND NEW GALVANIZED
STEEL PILES
ANGLE LAKE
GEARAO

SHEET 6 OF 12

DATE: 2/14/25

px://mof-use-pw-bentley.com/mof-use-pw/100Documents/507102134-Port of Chittick Boat Launch and Facilities Improvement/Drawings_Models/12_MA_Maint/7_Design/CAD/ - Permit/Arge Lake Permit - Sta Plandwg/Feb 14, 2025 - 4:17PM MOR69830

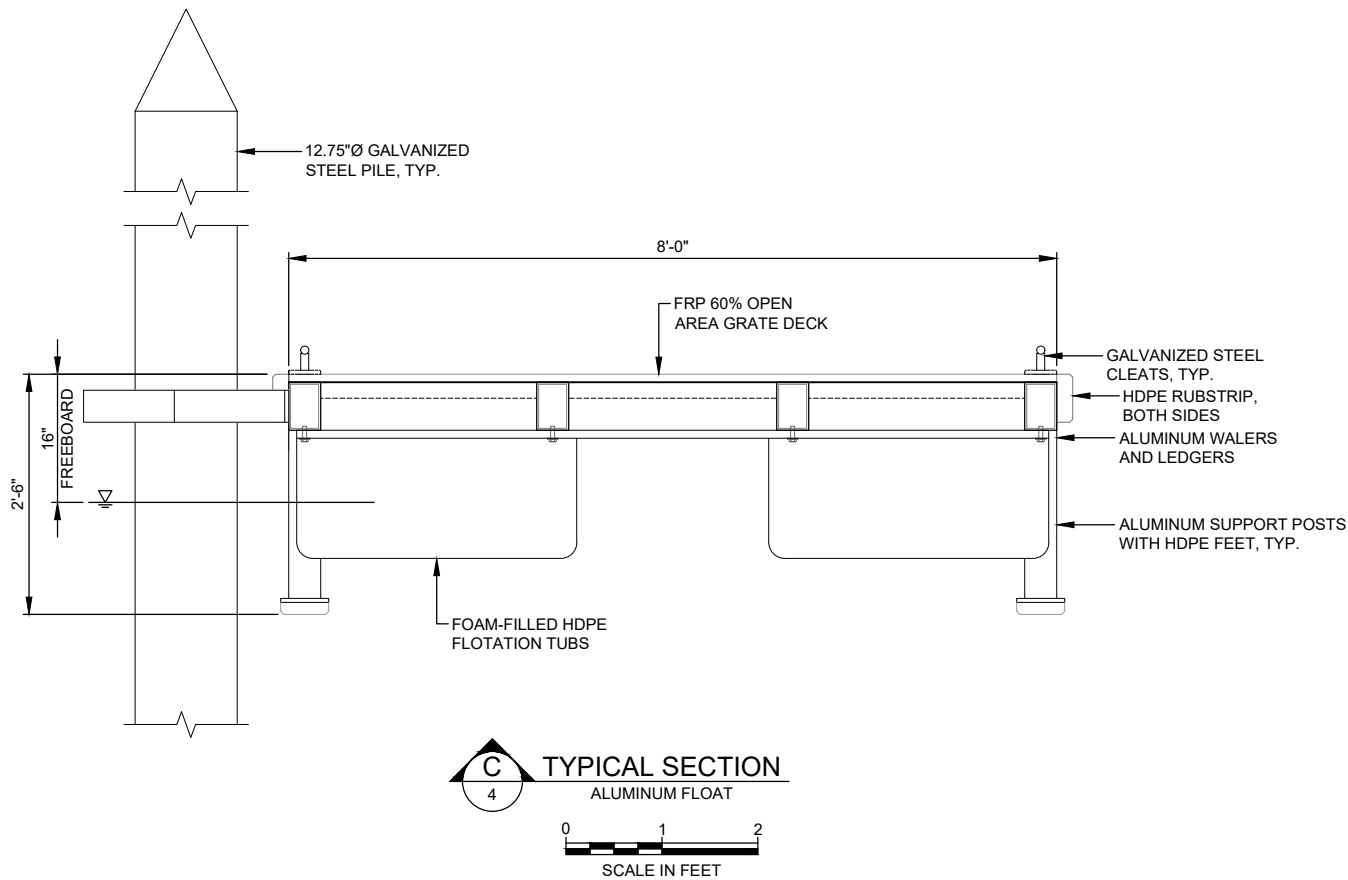
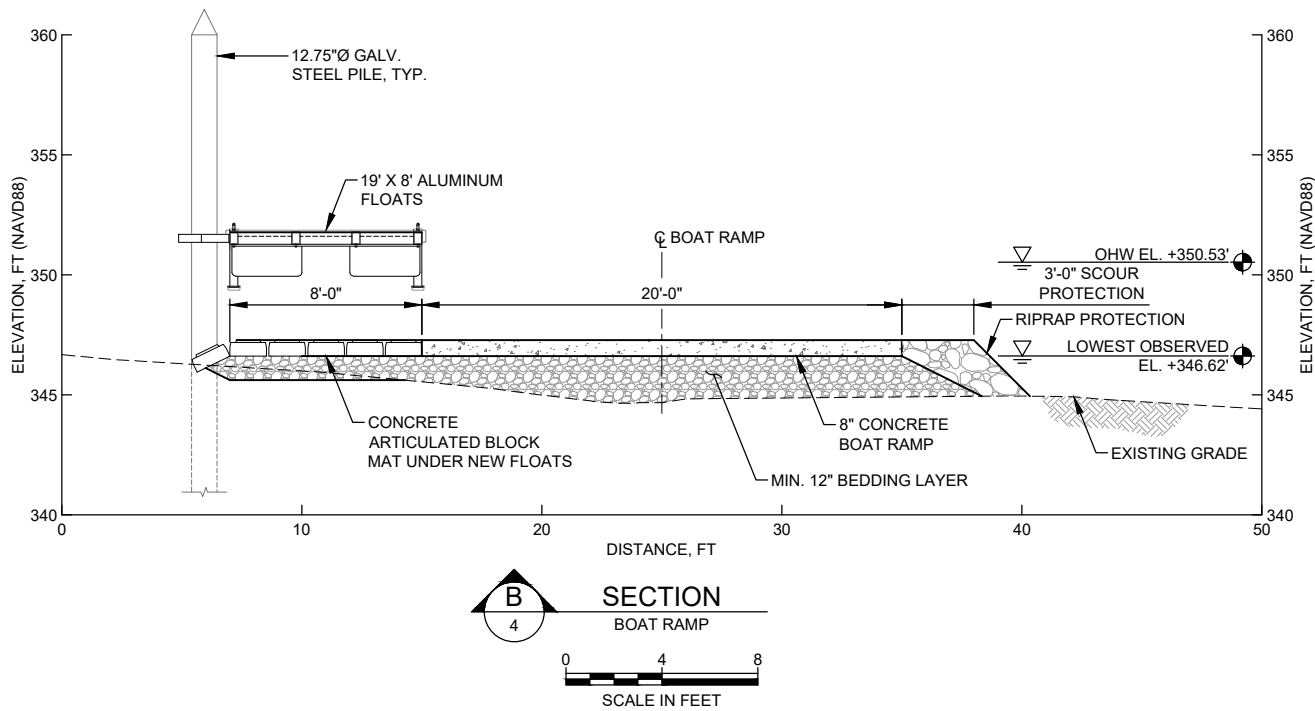

PURPOSE: REPLACE BOAT RAMP, PIER, PILES AND FLOATS

DATUM: NAD83 STATE PLANE WASHINGTON NORTH,
INTERNATIONAL FOOT (HORIZONTAL)
NAVD88 (VERTICAL)

ADJACENT PROPERTY OWNERS:

1. CITY OF SEATAC
2. KIMBERLY AND JIMMY VUONG (PARK PLACE PLAZA)
3. CHRISTOPHER THOMAS

ANGLE LAKE PARK
WATERFRONT
IMPROVEMENTS

RAMP SECTION

APPLICATION BY:
CITY OF SEATAC

PROPOSED: NEW CONCRETE BOAT RAMP AND PIERS, NEW
ALUMINUM FLOATS AND NEW GALVANIZED
STEEL PILES

IN: ANGLE LAKE

NEAR / AT: SEATAC

COUNTY: KING

STATE: WASHINGTON

SHEET 7 OF 12

DATE: 2/14/25

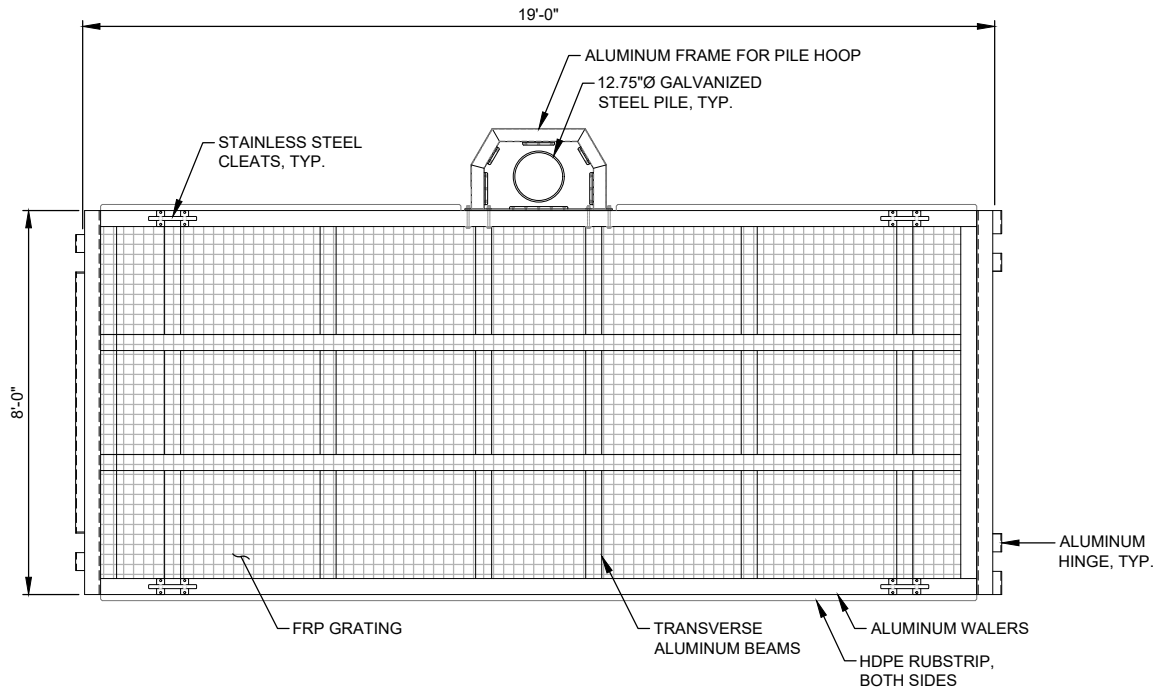

1
7

TYPICAL PLAN
19' X 8' ALUMINUM FLOAT

0 2 4
SCALE IN FEET

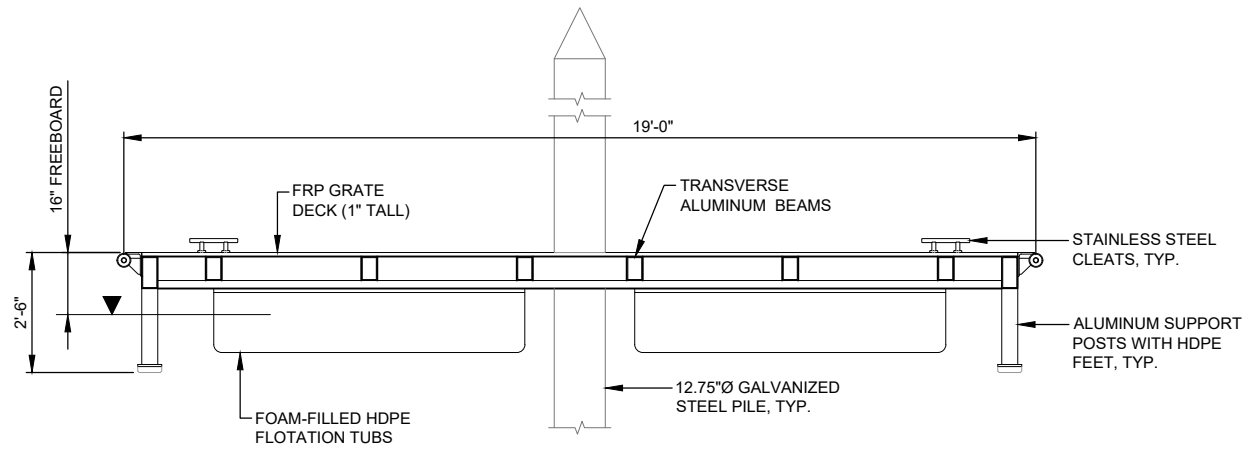

ELEVATION
19' X 6' ALUMINUM FLOAT

0 2 4
SCALE IN FEET

PURPOSE: REPLACE BOAT RAMP, PIER, PILES AND FLOATS

DATUM: NAD83 STATE PLANE WASHINGTON NORTH,
INTERNATIONAL FOOT (HORIZONTAL)
NAVD88 (VERTICAL)

ADJACENT PROPERTY OWNERS:

1. CITY OF SEATAC
2. KIMBERLY AND JIMMY VUONG (PARK PLACE PLAZA)
3. CHRISTOPHER THOMAS

**ANGLE LAKE PARK
WATERFRONT
IMPROVEMENTS**

FLOAT SECTION

APPLICATION BY:
CITY OF SEATAC

PROPOSED: NEW CONCRETE BOAT RAMP AND PIERS, NEW
ALUMINUM FLOATS AND NEW GALVANIZED
STEEL PILES

IN: ANGLE LAKE

NEAR / AT: SEATAC

COUNTY: KING

STATE: WASHINGTON

SHEET 8 **OF** 12

DATE: 2/14/25

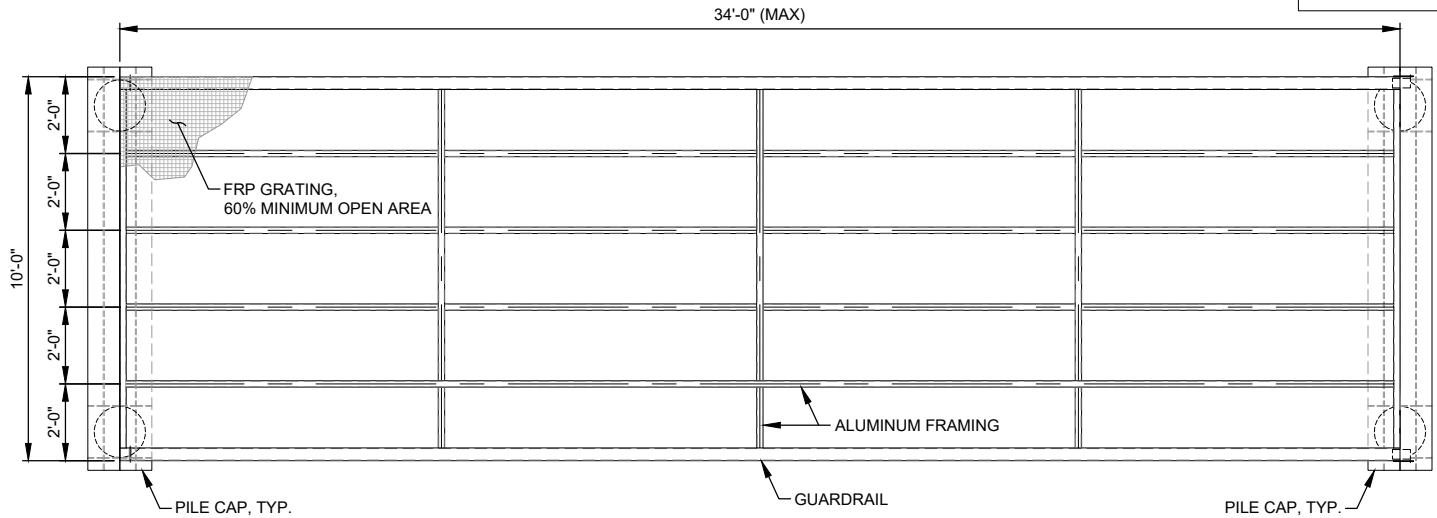

TYPICAL PIER PLAN

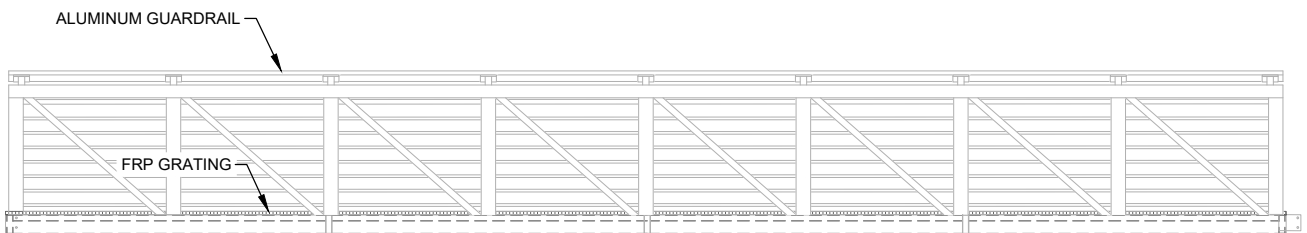
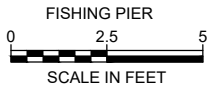

ELEVATION

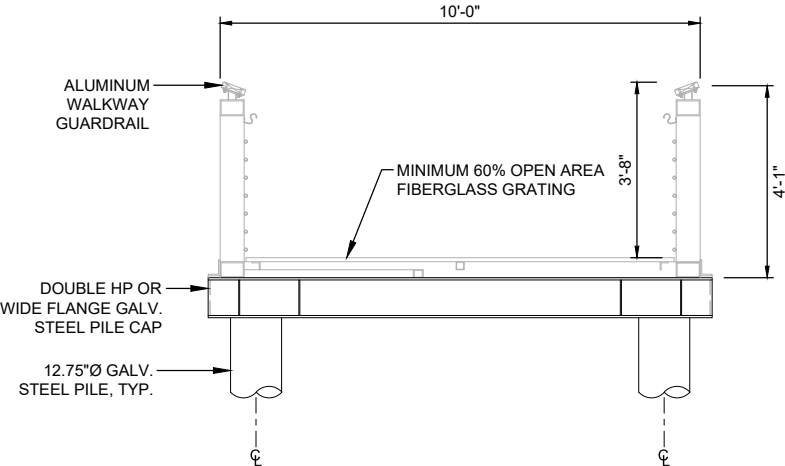
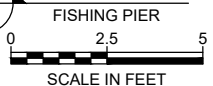

TYPICAL SECTION

FISHING PIER

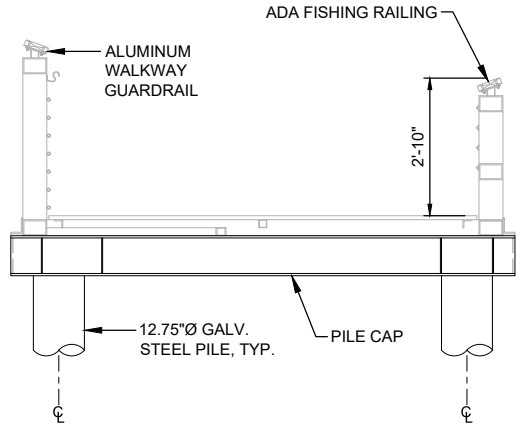

TYPICAL SECTION

FISHING PIER WITH ADA RAILING



PURPOSE: REPLACE BOAT RAMP, PIER, PILES AND FLOATS

DATUM: NAD83 STATE PLANE WASHINGTON NORTH,
INTERNATIONAL FOOT (HORIZONTAL)
NAVD88 (VERTICAL)

ADJACENT PROPERTY OWNERS:

1. CITY OF SEATAC
2. KIMBERLY AND JIMMY VUONG (PARK PLACE PLAZA)
3. CHRISTOPHER THOMAS

ANGLE LAKE PARK WATERFRONT IMPROVEMENTS

PIER SECTION

APPLICATION BY:
CITY OF SEATAC

PROPOSED: NEW CONCRETE BOAT RAMP AND PIERS, NEW
ALUMINUM FLOATS AND NEW GALVANIZED
STEEL PILES

IN: ANGLE LAKE

NEAR / AT: SEATAC

COUNTY: KING

STATE: WASHINGTON

SHEET 9 **OF** 12

DATE: 2/14/25

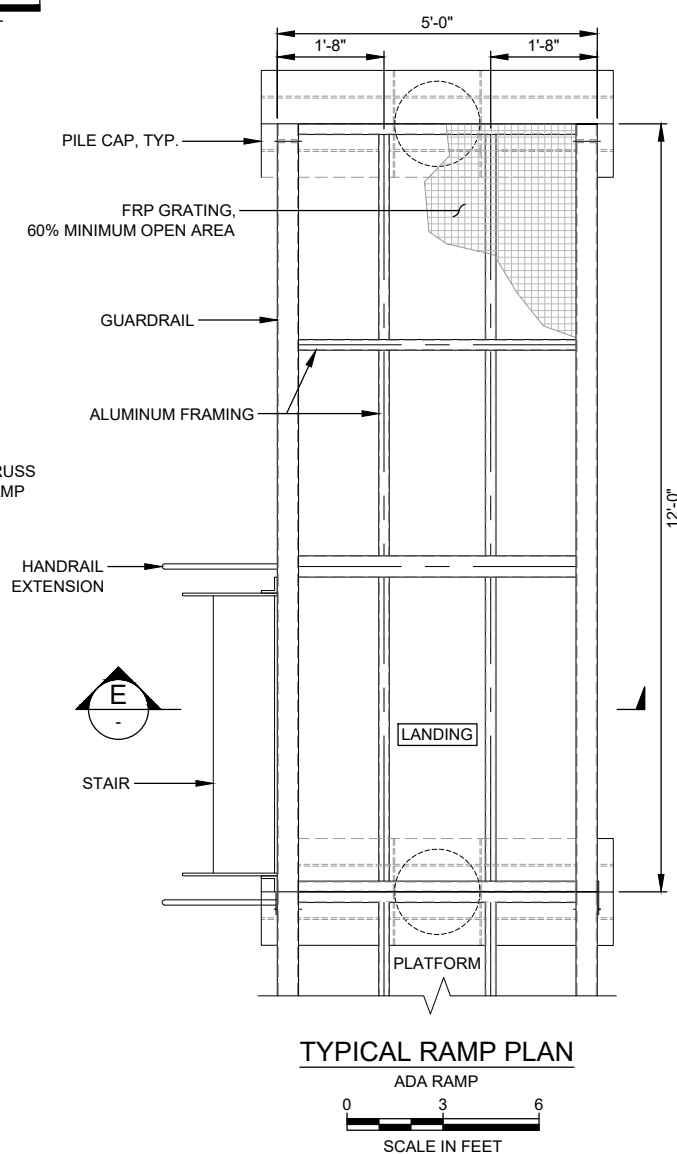
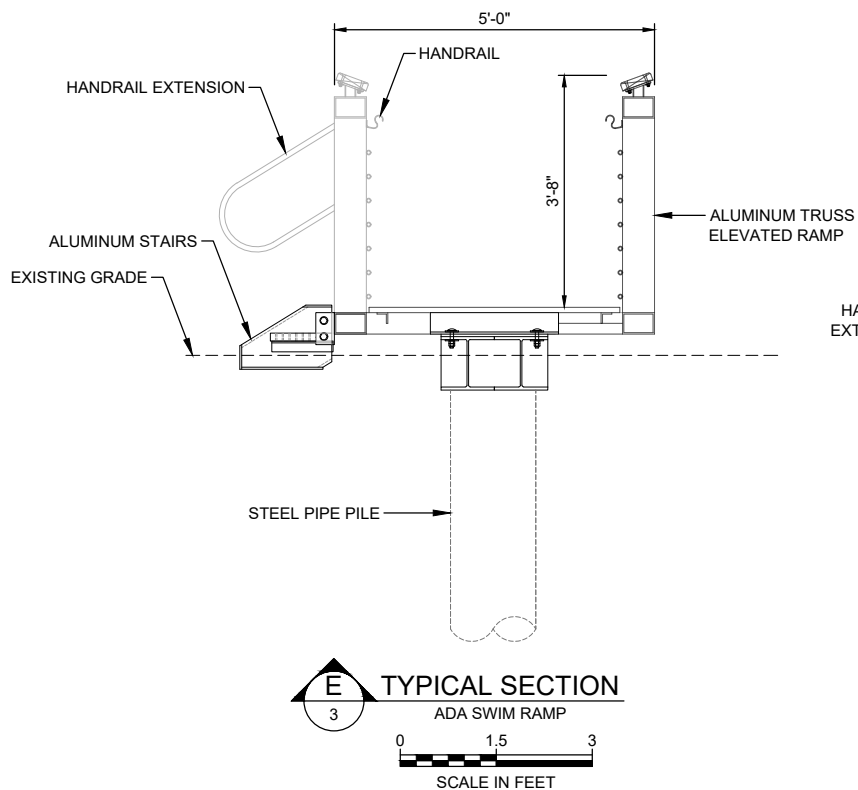
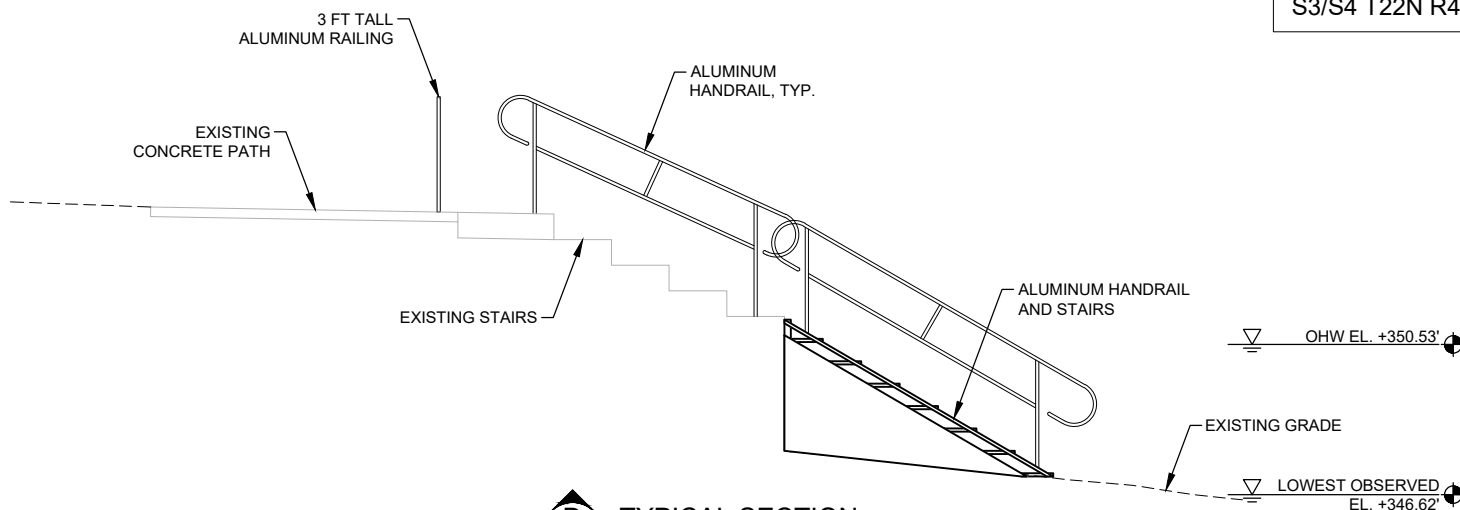

PURPOSE: REPLACE BOAT RAMP, PIER, PILES AND FLOATS

DATUM: NAD83 STATE PLANE WASHINGTON NORTH,
INTERNATIONAL FOOT (HORIZONTAL)
NAVD88 (VERTICAL)

ADJACENT PROPERTY OWNERS:

1. CITY OF SEATAC
2. KIMBERLY AND JIMMY VUONG (PARK PLACE PLAZA)
3. CHRISTOPHER THOMAS

ANGLE LAKE PARK WATERFRONT IMPROVEMENTS

ADA RAMP AND STAIRS SECTIONS

APPLICATION BY:
CITY OF SEATAC

PROPOSED:

NEW CONCRETE BOAT RAMP AND PIERS, NEW
ALUMINUM FLOATS AND NEW GALVANIZED
STEEL PILES

IN:

ANGLE LAKE

NEAR / AT:

SEATAC

COUNTY:

KING

STATE:

WASHINGTON

SHEET 10 OF 12

DATE: 2/14/25

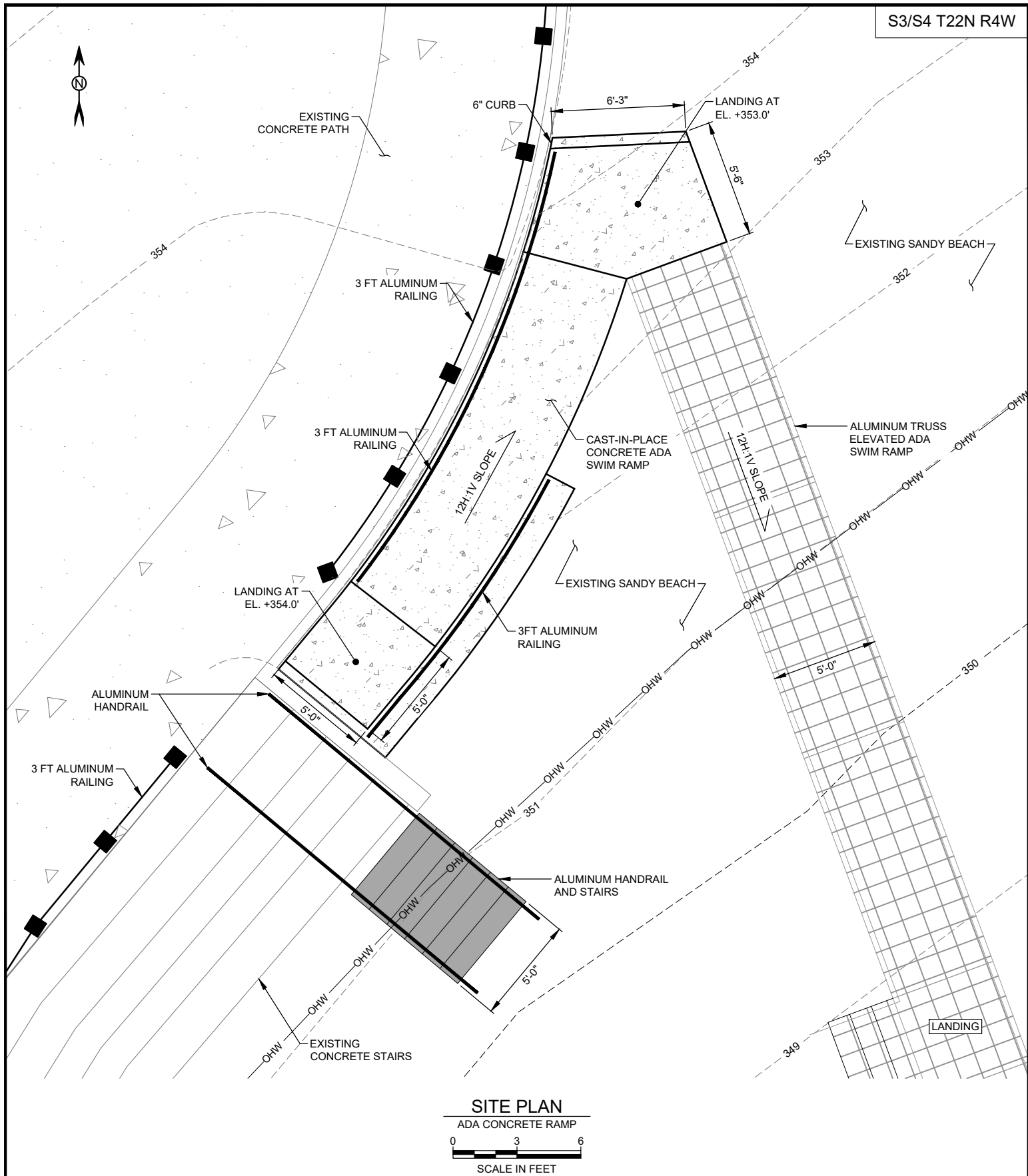

PURPOSE: REPLACE BOAT RAMP, PIER, PILES AND FLOATS

DATUM: NAD83 STATE PLANE WASHINGTON NORTH,
INTERNATIONAL FOOT (HORIZONTAL)
NAVD88 (VERTICAL)

ADJACENT PROPERTY OWNERS:

1. CITY OF SEATAC
2. KIMBERLY AND JIMMY VUONG (PARK PLACE PLAZA)
3. CHRISTOPHER THOMAS

ANGLE LAKE PARK WATERFRONT IMPROVEMENTS

ADA CONCRETE RAMP PLAN

APPLICATION BY:
CITY OF SEATAC

PROPOSED:

NEW CONCRETE BOAT RAMP AND PIERS, NEW
ALUMINUM FLOATS AND NEW GALVANIZED
STEEL PILES

IN:

ANGLE LAKE

NEAR / AT:

SEATAC

COUNTY:

KING

STATE:

WASHINGTON

SHEET 11 OF 12

DATE: 2/14/25

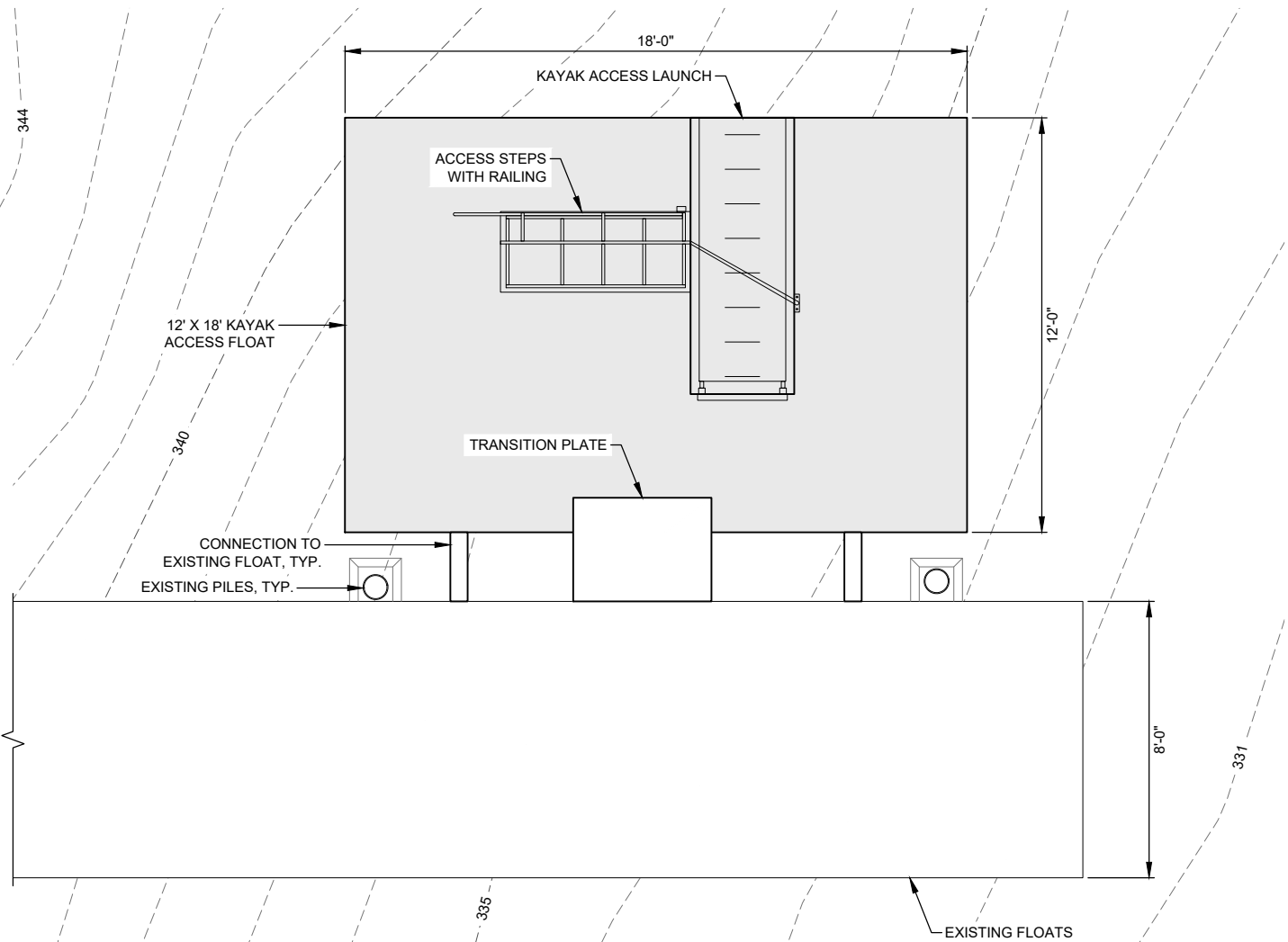

KAYAK ACCESS FLOAT PLAN



PURPOSE: REPLACE BOAT RAMP, PIER, PILES AND FLOATS

DATUM: NAD83 STATE PLANE WASHINGTON NORTH,
INTERNATIONAL FOOT (HORIZONTAL)
NAVD88 (VERTICAL)

ADJACENT PROPERTY OWNERS:

1. CITY OF SEATAC
2. KIMBERLY AND JIMMY VUONG (PARK PLACE PLAZA)
3. CHRISTOPHER THOMAS

ANGLE LAKE PARK
WATERFRONT
IMPROVEMENTS

KAYAK ACCESS FLOAT PLAN

APPLICATION BY:
CITY OF SEATAC

PROPOSED: NEW CONCRETE BOAT RAMP AND PIERS, NEW
ALUMINUM FLOATS AND NEW GALVANIZED
STEEL PILES

IN: ANGLE LAKE

NEAR / AT: SEATAC

COUNTY: KING

STATE: WASHINGTON

SHEET 12 **OF** 12

DATE: 2/14/25