

PRELIMINARY COVER SHEET
FOR
CELEBRATION OF LIFE PAVILION
A PORTION OF SE 1/4 OF THE NE 1/4, SEC. 28, T 23 N, R 4 E, W.M.
CITY OF SEA-TAC, KING COUNTY, WASHINGTON

GENERAL SITE DEVELOPMENT NOTES:

- THE GENERAL CONTRACTOR SHALL OBTAIN AND HAVE AVAILABLE COPIES OF THE APPLICABLE GOVERNING AGENCY STANDARDS AT THE JOB SITE DURING THE RELATED CONSTRUCTION OPERATIONS.
- GENERAL CONTRACTOR SHALL ASSURE THAT ALL NECESSARY PERMITS HAVE BEEN OBTAINED PRIOR TO COMMENCING WORK.
- THE GENERAL CONTRACTOR SHALL BE RESPONSIBLE FOR VERIFYING THE LOCATION, DIMENSION AND DEPTH OF ALL EXISTING UTILITIES PRIOR TO CONSTRUCTION WHETHER SHOWN ON THESE PLANS OR NOT. UTILITIES OTHER THAN THOSE SHOWN MAY EXIST ON THIS SITE. ONLY THOSE UTILITIES WITH EVIDENCE OF THEIR INSTALLATION VISIBLE AT GROUND SURFACE OR SHOWN ON RECORD DRAWING PROVIDED BY OTHERS ARE SHOWN HEREON. EXISTING UNDERGROUND UTILITY LOCATIONS SHOWN ARE APPROXIMATE ONLY AND ARE SUBJECT TO A DEGREE OF UNKNOWN VARIATION. SOME UNDERGROUND LOCATIONS SHOWN HEREON MAY HAVE BEEN TAKEN FROM PUBLIC RECORDS. BARGHAUSEN CONSULTING ENGINEERS, INC. ASSUMES NO LIABILITY FOR THE ACCURACY OF PUBLIC RECORDS OR RECORDS OF OTHERS. IF CONFLICTS SHOULD OCCUR, THE CONTRACTOR SHALL CONSULT BARGHAUSEN CONSULTING ENGINEERS, INC., TO RESOLVE ALL PROBLEMS PRIOR TO PROCEEDING WITH CONSTRUCTION.
- IT IS THE RESPONSIBILITY OF THE CONTRACTOR TO REVIEW ALL OF THE DRAWINGS AND SPECIFICATIONS ASSOCIATED WITH THE PROJECT WORK SCOPE PRIOR TO THE INITIATION OF CONSTRUCTION. SHOULD THE CONTRACTOR FIND A CONFLICT WITH THE DOCUMENTS RELATIVE TO THE SPECIFICATIONS OR THE RELATIVE CODES, IT IS THE CONTRACTOR'S RESPONSIBILITY TO NOTIFY THE PROJECT ENGINEER OF RECORD IN WRITING PRIOR TO THE START OF CONSTRUCTION. FAILURE BY THE CONTRACTOR TO NOTIFY THE PROJECT ENGINEER SHALL CONSTITUTE ACCEPTANCE OF FULL RESPONSIBILITY BY THE CONTRACTOR TO COMPLETE THE SCOPE OF WORK AS DEFINED BY THE DRAWINGS AND IN FULL COMPLIANCE WITH LOCAL REGULATIONS AND CODES.
- IT SHALL BE THE GENERAL CONTRACTOR'S RESPONSIBILITY TO NOTIFY THE APPROPRIATE UTILITIES INVOLVED PRIOR TO CONSTRUCTION.
- INSPECTION OF SITE WORK WILL BE THE RESPONSIBILITY OF THE ENGINEER. INSPECTION OF PRIVATE FACILITIES WILL BE ACCOMPLISHED BY A REPRESENTATIVE OF THE OWNER. IT SHALL BE THE CONTRACTOR'S RESPONSIBILITY TO NOTIFY THE INSPECTOR 24 HOURS IN ADVANCE OF BACKFILLING ALL CONSTRUCTION.
- PRIOR TO ANY CONSTRUCTION OR DEVELOPMENT ACTIVITY THE CONTRACTOR SHALL CONTACT THE AGENCY AND/OR UTILITY INSPECTION PERSONNEL AND ARRANGE ANY REQUIRED PRE-CONSTRUCTION MEETING(S). CONTRACTOR SHALL PROVIDE 72 HRS MIN. ADVANCE NOTIFICATION TO OWNER, FIELD ENGINEER AND ENGINEER OF PRE-CONSTRUCTION MEETINGS.
- THE GENERAL CONTRACTOR IS RESPONSIBLE FOR WORKER AND SITE SAFETY AND SHALL COMPLY WITH THE LATEST OSHA STANDARDS AND REGULATIONS, OR ANY OTHER AGENCY HAVING JURISDICTION FOR EXCAVATION AND TRENCHING PROCEDURES. THE CONTRACTOR IS RESPONSIBLE FOR DETERMINING THE "MEANS AND METHODS" REQUIRED TO MEET THE INTENT AND PERFORMANCE CRITERIA OF OSHA, AS WELL AS ANY OTHER ENTITY THAT HAS JURISDICTION FOR EXCAVATION AND/OR TRENCHING PROCEDURES.
- THE GENERAL CONTRACTOR SHALL BE RESPONSIBLE FOR PROVIDING ADEQUATE SAFEGUARDS, SAFETY DEVICES, PROTECTIVE EQUIPMENT, FLAGGERS, AND ANY OTHER NEEDED ACTIONS TO PROTECT THE LIFE, HEALTH, AND SAFETY OF THE PUBLIC, AND TO PROTECT PROPERTY IN CONNECTION WITH THE PERFORMANCE OF WORK COVERED BY THE CONTRACTOR. ANY WORK WITHIN THE TRAVELED RIGHT-OF-WAY THAT MAY INTERRUPT NORMAL TRAFFIC FLOW SHALL REQUIRE AT LEAST ONE FLAGGER FOR EACH LANE OF TRAFFIC AFFECTED.
- PROTECTIVE MEASURES SHALL BE TAKEN BY THE CONTRACTOR TO PROTECT ALL ADJACENT PUBLIC AND PRIVATE PROPERTIES AT ALL TIMES DURING CONSTRUCTION. THE CONTRACTOR SHALL BE RESPONSIBLE FOR PROTECTION OF ALL EXISTING UTILITY SERVICES THAT ARE TO REMAIN OPERATIONAL WITHIN THE CONSTRUCTION AREA WHETHER SHOWN OR NOT SHOWN ON THE PLANS.
- TWO (2) COPIES OF THESE APPROVED PLANS MUST BE ON THE JOB SITE WHENEVER CONSTRUCTION IS IN PROGRESS. ONE (1) SET WITH RECORDS OF AS-BUILT INFORMATION SHALL BE SUBMITTED TO BARGHAUSEN CONSULTING ENGINEERS, INC. AT COMPLETION OF PROJECT.
- GENERAL CONTRACTOR SHALL OBTAIN SERVICES OF A LICENSED LAND SURVEYOR TO STAKE HORIZONTAL CONTROL FOR ALL NEW IMPROVEMENTS. STAKING CONTROL SHALL BE TAKEN FROM ELECTRONIC PLAN FILES PROVIDED BY BCE.

LEGEND	
EXISTING	PROPOSED
CURB AND GUTTER	
BARRIER CURB	
CONCRETE	
GRAVEL	
ASPHALT	
PAINT STRIPING	
DIRECTIONAL ARROW	
SAWCUT	
BOLLARD	
SIGN	
BUILDING LINE	
CONTOURS	
WATER LINE	
FIRE HYDRANT	
WATER METER	
WATER VALVE	
FIRE DEPARTMENT CONN.	
POST INDICATOR VALVE	
STORM LINE	
CATCH BASIN TYPE 1	
CATCH BASIN TYPE 2	
SANITARY SEWER LINE	
SANITARY SEWER MANHOLE	
CLEANOUT (AS NOTED)	
POWER OVERHEAD	
POWER UNDERGROUND	
POWER METER	
UTILITY POLE	
JUNCTION BOX (TYPE 1,2,3)	
LUMINAIRE	
YARD LIGHT	
TELEPHONE	
GAS	
GAS METER	
GAS VALVE	

VERTICAL DATUM:
VERTICAL DATUM FOR THIS SURVEY IS NAVD83 ESTABLISHED BY GPS OBSERVATION UTILIZING THE WASHINGTON STATE REFERENCE NETWORK (WSRN) USING NGS GEOID 2018.

HORIZONTAL DATUM:
HORIZONTAL DATUM FOR THIS SURVEY IS NAD 83/2011, WASHINGTON STATE COORDINATE SYSTEM, SOUTH ZONE, ESTABLISHED BY GPS OBSERVATION UTILIZING THE WASHINGTON STATE REFERENCE NETWORK (WSRN).

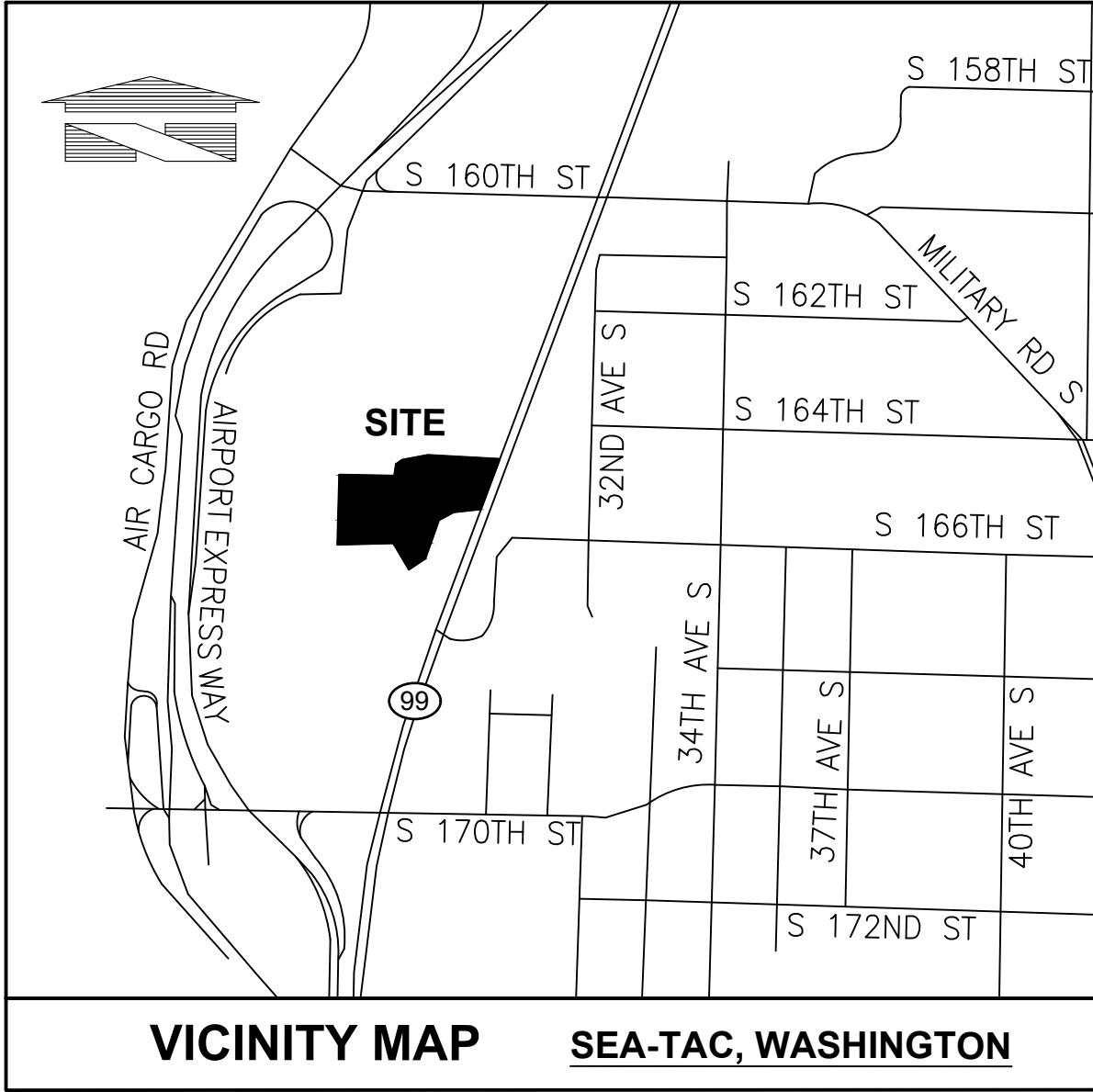
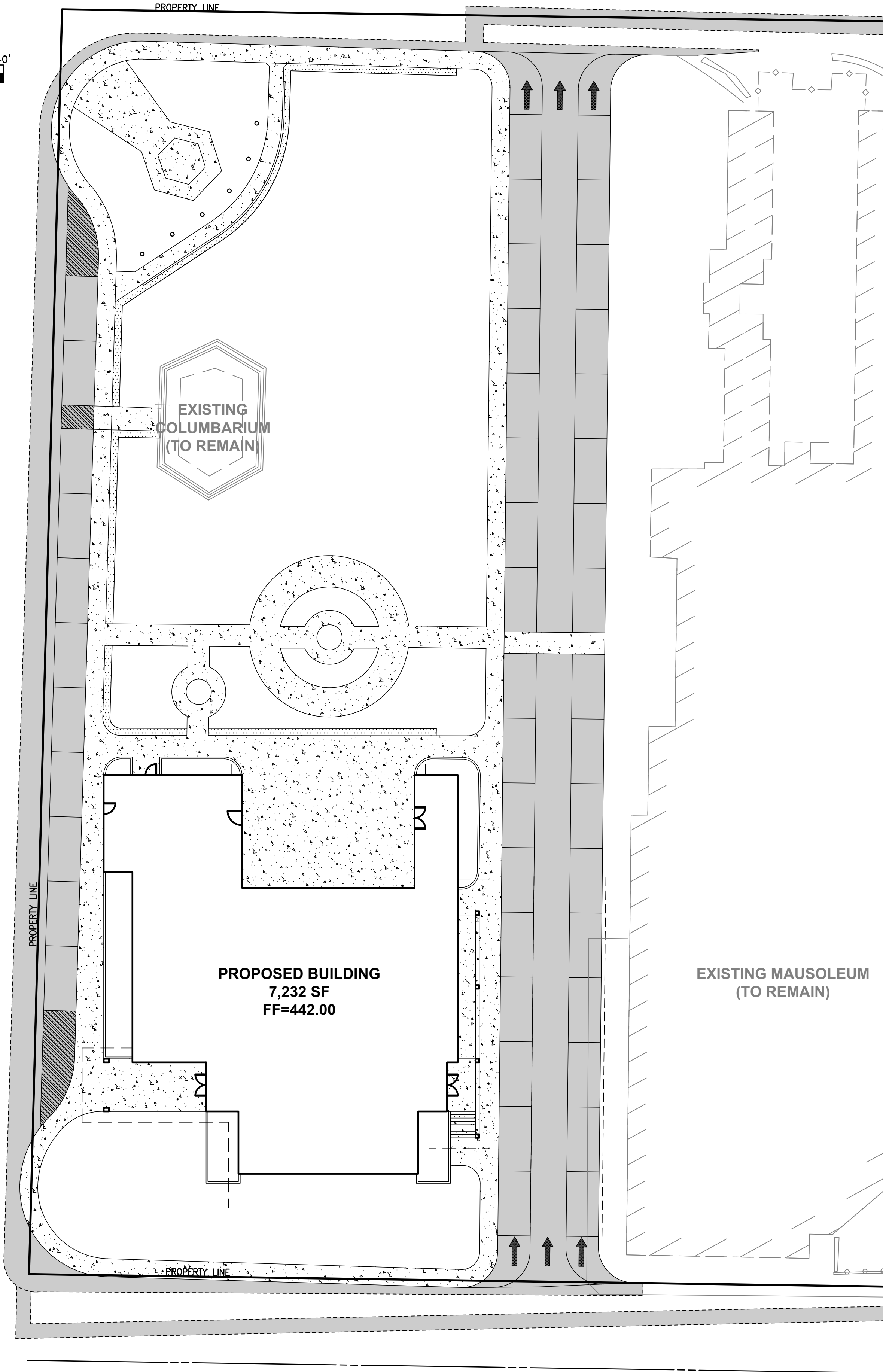
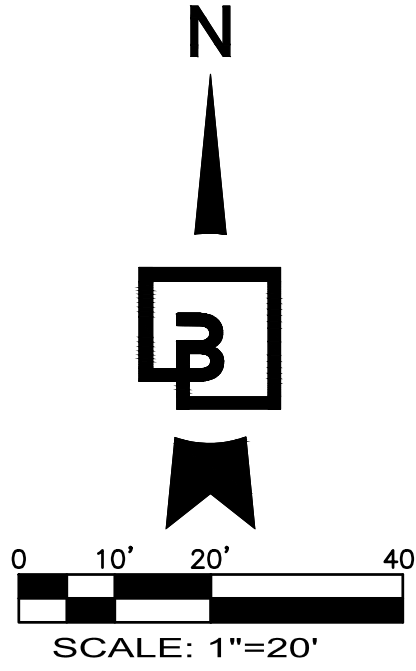

EXISTING CONDITIONS
FOR
CELEBRATION OF LIFE PAVILION
A PORTION OF SE 1/4 OF THE NE 1/4, SEC. 28, T 23 N, R 4 E, W.M.
CITY OF SEA-TAC, KING COUNTY, WASHINGTON

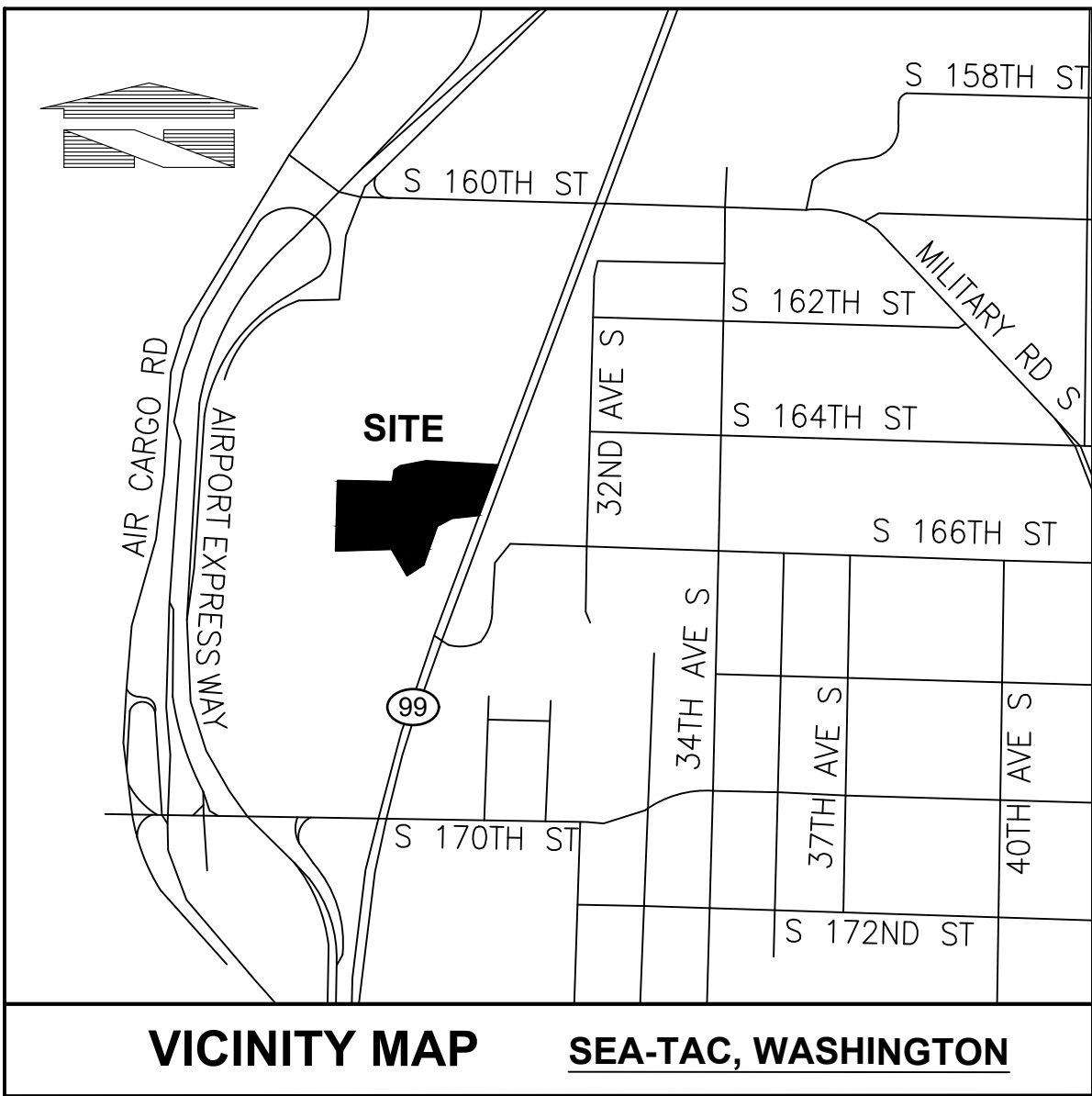

VICINITY MAP SEA-TAC, WASHINGTON

LEGEND

- | | | | |
|--|--------------------------------|--|----------------------------------|
| | POWER VAULT | | SURVEY MONUMENT (AS NOTED) |
| | TELEPHONE VAULT | | SECTION CORNER (AS NOTED) |
| | WATER VAULT | | FND. SURVEY MARKER (AS NOTED) |
| | STREET LIGHT | | ASPHALT |
| | LOT LIGHT OR LAMP | | CONCRETE |
| | POWER METER | | GRAVEL |
| | POWER POLE | | SS — SANITARY SEWER LINE |
| | GUY WIRE | | SD — STORM DRAINAGE LINE |
| | TRAFFIC SIGNAL | | — CHAIN LINK FENCE |
| | PEDESTRIAN PUSH BUTTON | | — WOOD FENCE |
| | JUNCTION BOX (JBOX) | | — SIL FENCE |
| | TELEPHONE MANHOLE (TMH) | | — GUARD RAIL / HAND RAIL |
| | CATCH BASIN (CB) | | W — WATER VIA PAINTMARKS |
| | STORM MANHOLE (SDMH) | | G — GAS VIA PAINTMARKS |
| | SANITARY SEWER MANHOLE (SSMH) | | T(UG) — TELEPHONE VIA PAINTMARKS |
| | SANITARY SEWER CLEANOUT (SSCO) | | P(UG) — POWER VIA PAINTMARKS |
| | GAS METER (GM) | | P(CH) — OVERHEAD POWER LINES |
| | GAS VALVE | | — EVERGREEN TREE W/SIZE |
| | WATER VALVE (WV) | | — DECIDUOUS TREE W/SIZE |
| | FIRE CONNECTION (FPSP) | | |
| | FIRE HYDRANT (HYD) | | |
| | WATER MANHOLE (WMH) | | |
| | WATER METER (WM) | | |
| | SPRINKLER | | |
| | IRRIGATION BOX (IRR) | | |
| | IRRIGATION VALVE (IRR) | | |
| | SIGN | | |

NOTE: NOT ALL SYMBOLS WILL APPEAR IN THE DRAWING

HORIZONTAL DATUM: NAD 83/91

BASIS OF BEARINGS:
SOUTH 02°33'34" WEST, AS MEASURED BETWEEN WSDOT MONUMENTS 3698 (GP17518-259) AND 3161 (GP17099-226).

VERTICAL DATUM: NORTH AMERICAN VERTICAL DATUM OF 1988.

BENCHMARK: WSDOT MONUMENTS 3698 (GP17518-259), BEING THE TOP OF A FOUND 3" BRASS DISK W/ PUNCH MARKED "GP17518-259" IN PIPE CASING IN FLUSH WITH NORTHERLY SIDE OF SR518 OVERPASS BRIDGE DECK.
ELEVATION = 412.48 U.S. FEET (NAVD 88)

DATES OF SURVEY:
FIELD SURVEY BY BARGHAUSEN CONSULTING ENGINEERS, INC. CONDUCTED IN SEPTEMBER, 2016. (POND AREA ON 2/19/21)

PROCEDURE / NARRATIVE:
A FIELD TRAVERSE USING A TOPCON GT 1000 TOTAL STATIONS, TOPCON HYPER HR SUPPLEMENTED WITH DELTA TABLET, MAGNET FIELD SOFTWARE AND FIELD NOTES, WAS PERFORMED, ESTABLISHING THE ANGULAR, VERTICAL AND DISTANCE RELATIONSHIPS BETWEEN THE MONUMENTS, PROPERTY LINES AND IMPROVEMENTS. THE RESULTING DATA MEETS OR EXCEEDS THE STANDARDS FOR LAND BOUNDARY SURVEYS AS SET FORTH IN WAC 332-130-090.

SURVEY NOTES:
1. UNDERGROUND UTILITIES AND FEATURES DEPICTED HEREON ARE BASED ON FIELD OBSERVATION, MARKINGS, DEVELOPMENT PLANS, AND/OR AVAILABLE RECORD DOCUMENTS ONLY. THE TRUE LOCATION, NATURE AND/OR EXISTENCE OF BELOW GROUND FEATURES, DETECTED OR UNDETECTED, SHOULD BE VERIFIED.

3. ALL DISTANCES ARE IN US FEET

4. THIS IS NOT A BOUNDARY SURVEY. NO BOUNDARY RELATED MONUMENTATION WAS LOCATED DURING THIS SURVEY.

5. NO TITLE REPORT WAS RECEIVED OR REVIEWED FOR THIS SURVEY.

6. ELEMENTS AND FEATURES DEPICTED HEREON SATISFY THE REQUIREMENTS STATED WITHIN W.A.C. 332-130-145 FOR TOPOGRAPHIC MAPS, INCLUDING THE FOLLOWING: THE SOURCE OF THE CONTOURS SHOWN HEREON ARE BASED UPON DIRECT FIELD OBSERVATIONS. THE CONTOUR ACCURACY IS PER NATIONAL MAPPING STANDARDS, ONE HALF OF THE CONTOUR INTERVAL (2'). THE PURPOSE OF THIS SURVEY IS TO MAP THE CURRENT CONDITIONS FOR ARCHITECTURAL/ENGINEERING DESIGN.

SURVEYOR'S CERTIFICATE:

THIS IS TO CERTIFY THAT THIS MAP AND THE SURVEY UPON WHICH IT IS BASED WERE MADE BY ME OR UNDER MY DIRECTION AND CORRECTLY REFLECTS THE CONDITIONS OF THIS SITE AS OF THE DATE OF THE FIELD SURVEY.

OWEN B. HILLE P.L.S.
WASHINGTON REGISTRATION NO. 40016

DATE



EXISTING CONDITIONS

Title:

For: BONNEY WATSON FUNERAL HOME
16445 INTERNATIONAL BLVD
SEATAC, WA 98188



Scale: Horizontal 1"=20' Vertical N/A

Designed LRP Drawn LRP Checked CMV Approved CMV Date 6/5/2024

Barghausen Consulting Engineers, Inc.
18215 72nd Avenue South
Kent, WA 98032
425.251.6222
barghausen.com

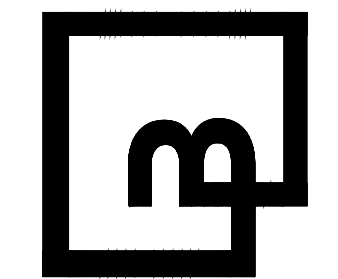

Job Number 20413 Sheet 2 of 2

PRELIMINARY SITE PLAN
FOR
CELEBRATION OF LIFE PAVILION
A PORTION OF SE 1/4 OF THE NE 1/4, SEC. 28, T 23 N, R 4 E, W.M.
CITY OF SEA-TAC, KING COUNTY, WASHINGTON

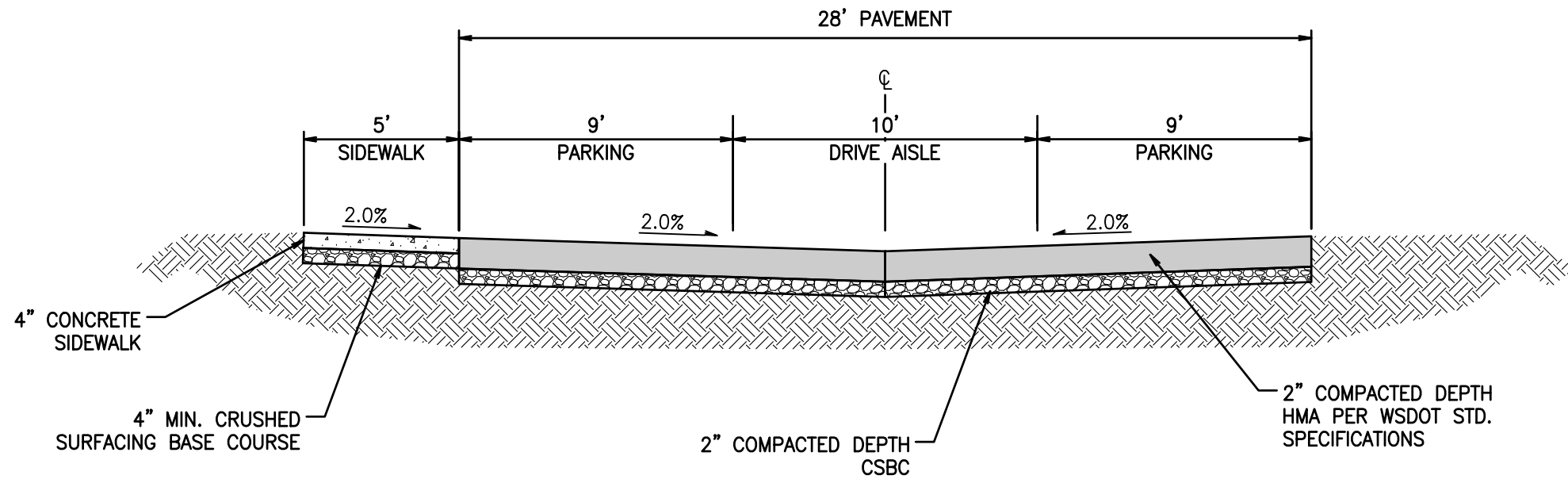
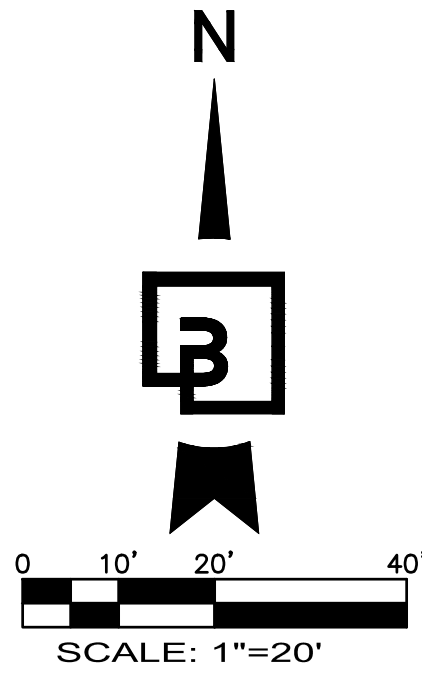

A DRIVE AISLE
SCALE: NOT TO SCALE

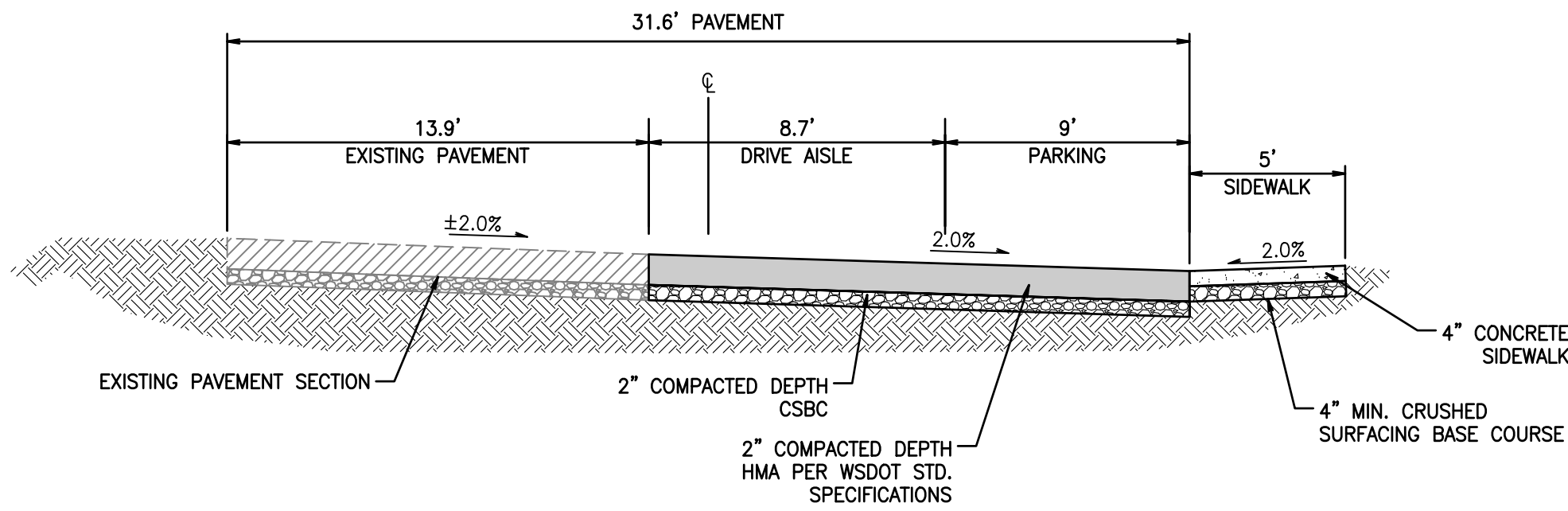

B DRIVE AISLE
SCALE: NOT TO SCALE

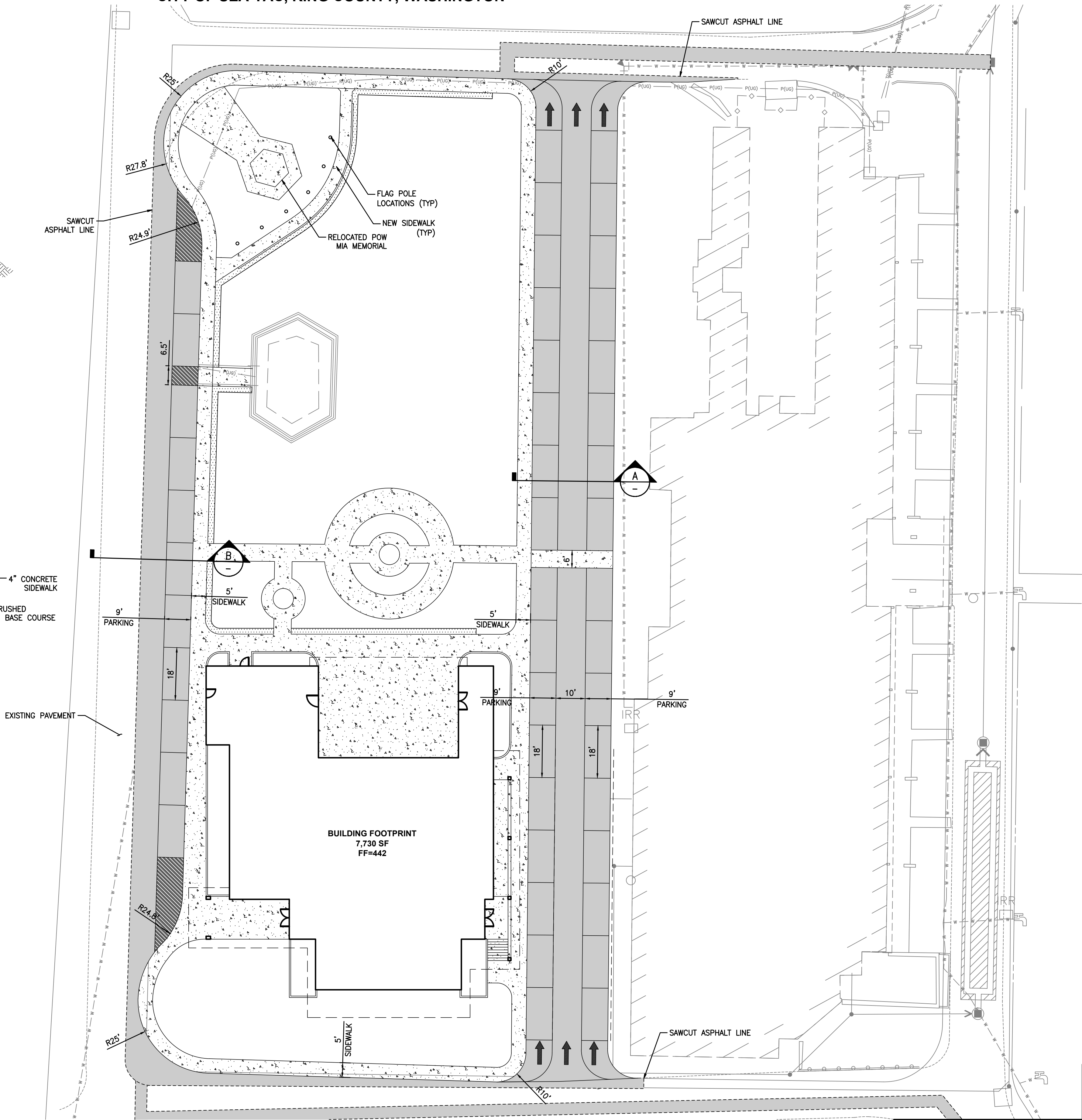

CALL BEFORE YOU DIG:
1-800-424-5555

UTILITY CONFLICT NOTE:
THE CONTRACTOR SHALL BE RESPONSIBLE FOR VERIFYING THE LOCATION, DIMENSION, AND DEPTH OF ALL EXISTING UTILITIES WHETHER SHOWN ON THESE PLANS OR NOT BY POT-HOLING THE UTILITIES AND SURVEYING THE HORIZONTAL AND VERTICAL LOCATION PRIOR TO CONSTRUCTION. THIS SHALL INCLUDE CALLING UTILITY LOCATE @ 1-800-424-5555 AND THEN POT-HOLING ALL OF THE EXISTING UTILITIES AT LOCATIONS OF NEW UTILITY CROSSINGS TO PHYSICALLY VERIFY WHETHER OR NOT CONFLICTS EXIST. LOCATIONS OF SAID UTILITIES AS SHOWN ON THESE PLANS ARE BASED UPON THE UNVERIFIED PUBLIC INFORMATION AND ARE SUBJECT TO VARIATION. IF CONFLICTS SHOULD OCCUR, THE CONTRACTOR SHALL CONSULT BARGHAUSEN CONSULTING ENGINEERS, INC. TO RESOLVE ALL PROBLEMS PRIOR TO PROCEEDING WITH CONSTRUCTION.

Revision		Title:		PRELIMINARY SITE PLAN	
No.	Date	By	Chd.	Appr.	
For: BONNEY WATSON FUNERAL HOME 16445 INTERNATIONAL BLVD SEATAC, WA 98188					
Scale:		Horizontal 1"=20' Vertical N/A			
Designed LRP		Date 6/5/2024			
Drawn LRP					
Checked CMV					
Approved CMV					
Barghausen Consulting Engineers, Inc. 18215 72nd Avenue South Kent, WA 98032 425.251.6222 barghausen.com					
Job Number	20413	Sheet	3	of	X

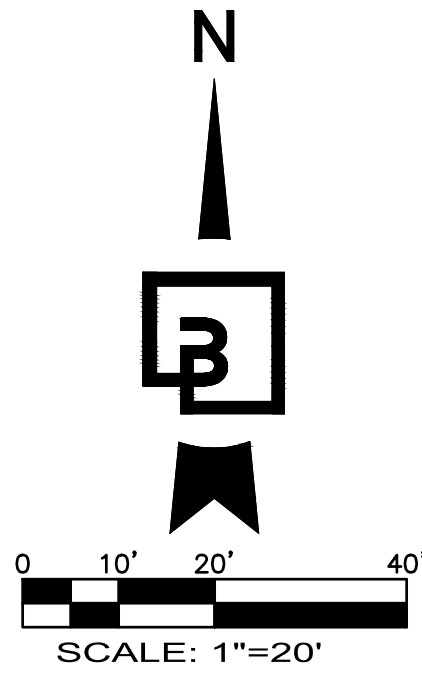

PRELIMINARY GRADING AND UTILITY PLAN
FOR
CELEBRATION OF LIFE PAVILION
A PORTION OF SE 1/4 OF THE NE 1/4, SEC. 28, T 23 N, R 4 E, W.M.
CITY OF SEA-TAC, KING COUNTY, WASHINGTON

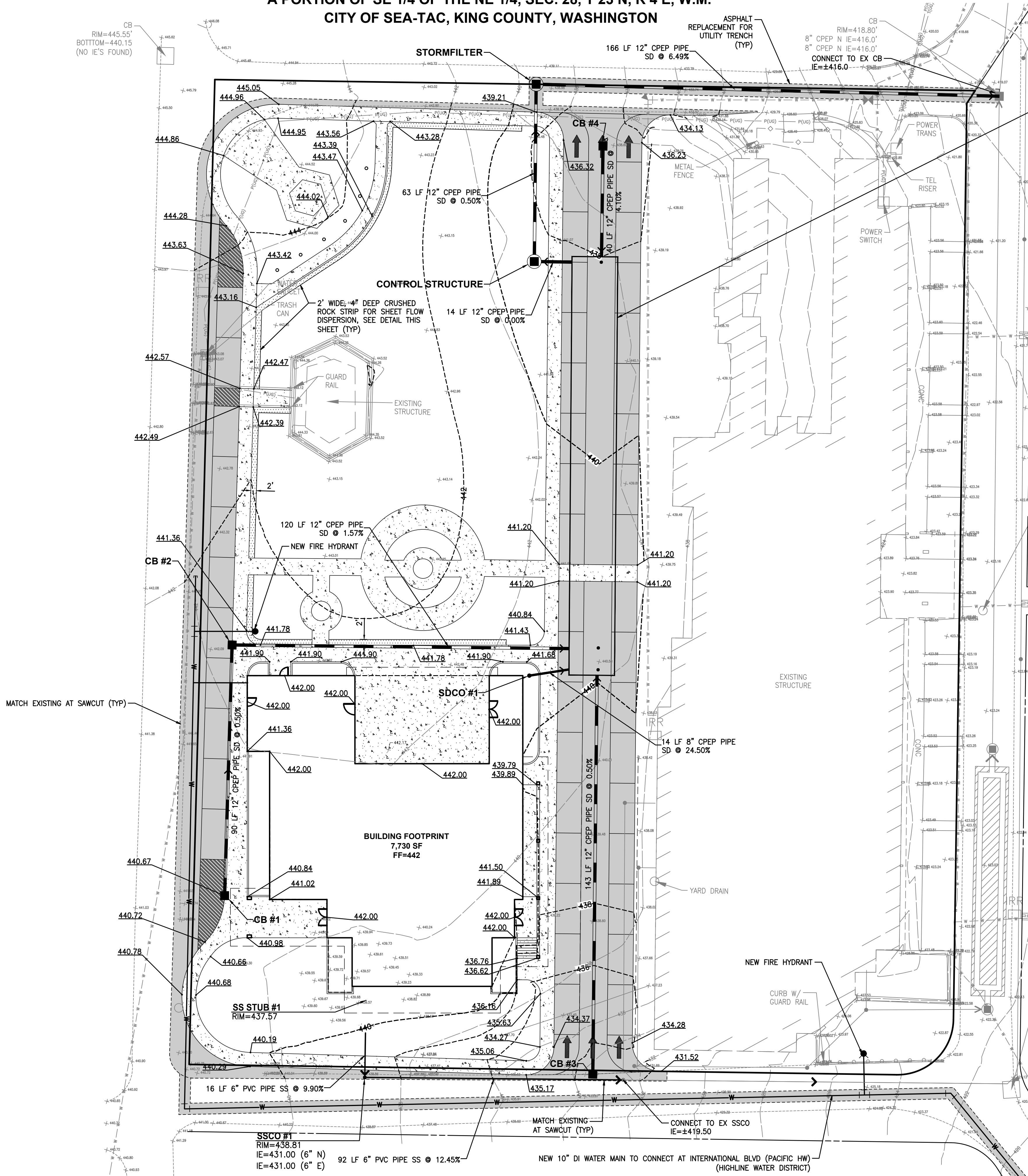

R TANK DETENTION SYSTEM

±805 R-TANK HD (PENTA) MODULES
TOP EL = 436.33'
DESIGN WATER SURFACE EL = 435.83'
BOTTOM OF DETENTION EL = 429.37'
VOLUME REQUIRED = 17,468 CF
VOLUME PROVIDED = ±17,842 CF

CATCH BASINS

CB #1, TYPE 1, W/STANDARD GRATE RIM=440.67 IE=437.67 (12" N)
CB #2, TYPE 1, W/STANDARD GRATE RIM=441.41 IE=437.22 (12" S) IE=437.22 (12" E)
CB #3, TYPE 1, W/STANDARD GRATE RIM=433.61 IE=430.61 (12" N)
CB #4, TYPE 1, W/STANDARD GRATE RIM=436.03 IE=433.71 (12" S)
CONTROL STRUCTURE, TYPE 2 RIM=438.82 IE=429.37 (12" E) IE=429.37 (12" N)
SDCO #1, ROOF DRAIN CONNECTION RIM=440.04 IE=439.00 (8" E)
STORMFILTER, RIM=432.31 IE=429.05 (12" S) IE=426.75 (12" E)

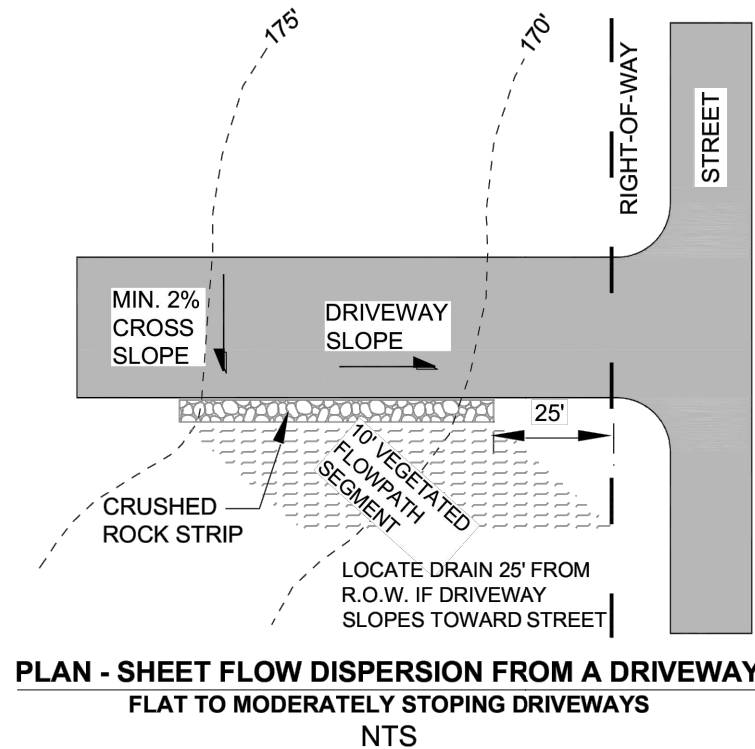

CALL BEFORE YOU DIG:
1-800-424-5555

UTILITY CONFLICT NOTE:

THE CONTRACTOR SHALL BE RESPONSIBLE FOR VERIFYING THE LOCATION, DIMENSION, AND DEPTH OF ALL EXISTING UTILITIES WHETHER SHOWN ON THESE PLANS OR NOT BY POT-HOLING THE UTILITIES AND SURVEYING THE HORIZONTAL AND VERTICAL LOCATION PRIOR TO CONSTRUCTION. THIS SHALL INCLUDE CALLING UTILITY LOCATE @ 1-800-424-5555 AND THEN POT-HOLING ALL OF THE EXISTING UTILITIES AT LOCATIONS OF NEW UTILITY CROSSINGS TO PHYSICALLY VERIFY WHETHER OR NOT CONFLICTS EXIST. LOCATIONS OF SAID UTILITIES AS SHOWN ON THESE PLANS ARE BASED UPON THE UNVERIFIED PUBLIC INFORMATION AND ARE SUBJECT TO VARIATION. IF CONFLICTS SHOULD OCCUR, THE CONTRACTOR SHALL CONSULT BARGHAUSEN CONSULTING ENGINEERS, INC. TO RESOLVE ALL PROBLEMS PRIOR TO PROCEEDING WITH CONSTRUCTION.

No.	Date	By	Chd.	Appr.

Title:
PRELIMINARY GRADING AND UTILITY PLAN
CELEBRATION OF LIFE PAVILION

For:
BONNEY WATSON FUNERAL HOME
16445 INTERNATIONAL BLVD
SEATAC, WA 98188



Scale:	Horizontal	1"=20'	Vertical	N/A
Designed LRP	Drawn LRP	Checked CMV	Approved CMV	Date 6/5/2024

Barghausen Consulting Engineers, Inc.
18215 72nd Avenue South
Kent, WA 98032
425.251.6222 barghausen.com

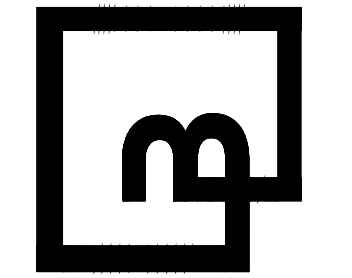

Job Number	20413	Sheet	4 of X
------------	-------	-------	--------